

TECHNICAL DATA

SERIES 2500 FRAMING SYSTEM

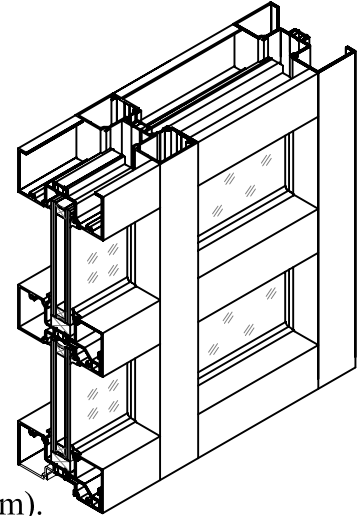

- DESCRIPTION: FLUSH GLAZED THERMALLY BROKEN SYSTEM.
PROFILE DIM. 2" x 4-1/2" (50.8 x 114.3mm).
- COMPATIBILITY: DESIGNED TO SUIT ALL STANDARD DOORS AND DOOR HARDWARE.
- FINISH: MOST PROFILES ARE STOCKED IN #17 CLEAR AND #40 BRONZE ANODIZED. OTHER ANODIZED AND PAINT FINISHES ARE AVAILABLE UPON REQUEST.
- STOCK LENGTH: 24'-2" (7.37 METERS).
- ASSEMBLY: DESIGNED FOR SCREW PORT AND/OR BRACKET ASSEMBLY.
- STRENGTH: REFER TO WIND LOAD CHARTS FOR MAXIMUM ALLOWABLE SPANS.
- ANCHORING: REFER TO FABRICATION AND INSTALLATION MANUAL.
- GLAZING: 2500 SERIES IS DESIGNED TO BE GLAZED FROM EXTERIOR AND WILL ACCEPT 1" (25.4mm) SEALED UNIT GLASS, REFER TO APPLICABLE DETAILS. IF GLAZING FROM INTERIOR IS REQUIRED, CONTACT COMMDOOR ALUMINUM FOR DETAILS.